

# LED PANEL LIGHT USER MANUAL

**MODEL NO.:**  
ELED122  
ELED172  
ELED225



## CAUTION

1. The "warranty Period" is three (3) years. if the unit fails and under warranty we will repair or replace the product. please send back the product to your local distributor.
2. Never modify the unit as there are no user serviceable parts inside.
3. The fittings is intended for dry environments only.
4. Light Source Maintenance: the light source of this luminaire is not replaceable; in case the light source need to be replaced (e.g. at the end of its life), the whole luminaire shall be replaced.
5. For further information, please contact us.

Please ensure that you install and use the product according to the below instructions to enable the correct implementation and normal functioning of the LED product. Should you not follow these instructions, you will not be compensated in accordance with the warranty, we will not take any responsibility from the improper use and implementation of the product, and for any associated damage caused.

## Installation Process

Installation must be performed by a skilled electrician who is familiar with the appropriate standards and technical requirements of the appliance and its proper installation.

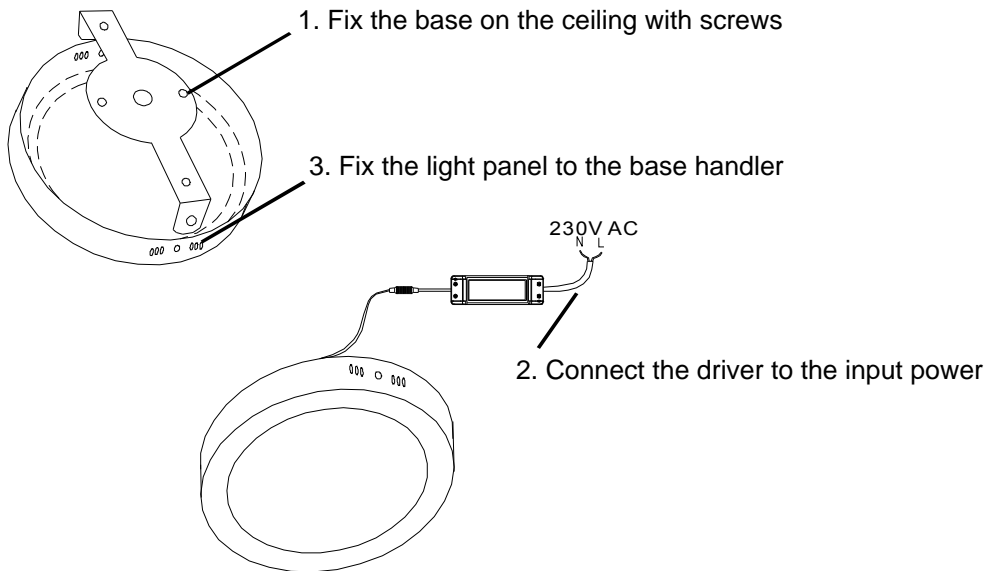

Optical			
Item No.	ELED122	ELED172	ELED225
CCT (Typical)	3000K / 4000K / 6000K		
Luminous Flux (Lm)	400Lm	750Lm	1200Lm
Typical Luminous Efficacy	66Lm/W	62.5Lm/W	60Lm/W
CRI (Ra)	>80		
Beam Angle	120°		
Mechanical and Dimension			
Outline Dim.	Ø122x35mm	Ø172x35mm	Ø225x35mm
Net Weight	235 g	460 g	800 g
Cover	Frosted	Frosted	Frosted
IP Rating	IP 20		
Electrical			
Typical Power Consumption	6W	12W	20W
Driver Input voltage	100-240V AC		
Driver Output Voltage	18-24V DC	30-55V DC	30-55V DC
Temperature Condition			
Operating Temperature	-20°C - +50°C		
Storage Temperature	-40°C - +85°C		

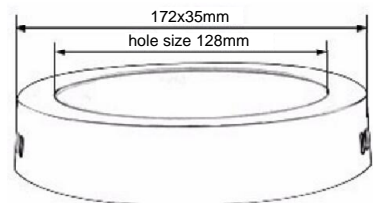
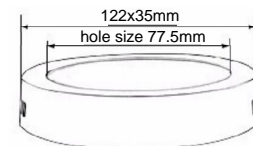

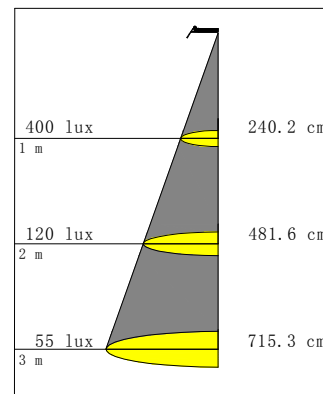
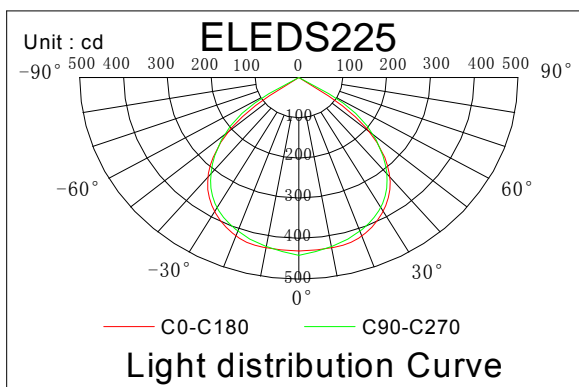
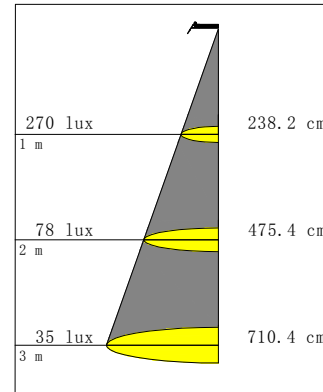
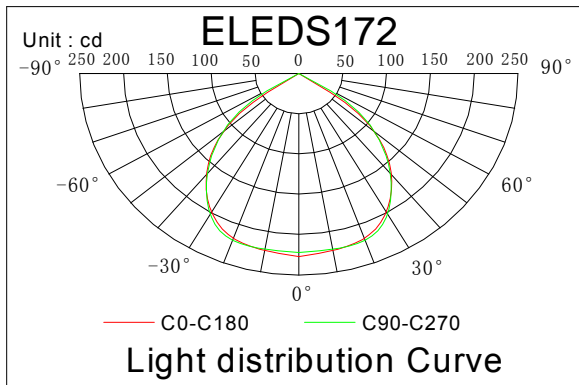
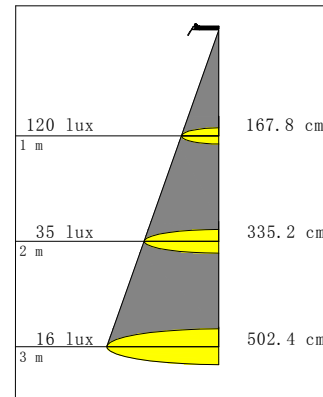
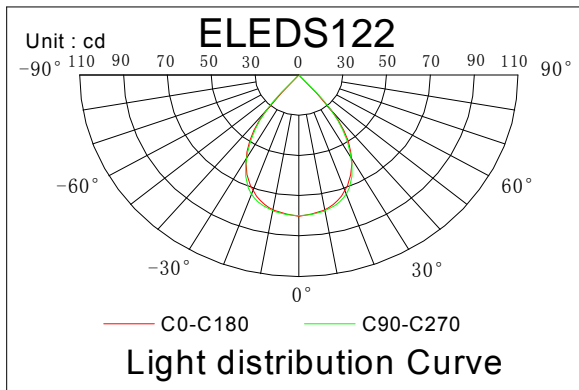

Due to our policy of continuous improvement we reserve the right to change specification without prior notice. Errors and omissions excepted. These instructions have been carefully checked prior to publication. However, no responsibility can be accepted by Challenger Security Products for any misinterpretation of these

**Distributed by:**

E-Matic Energy Management Solutions  
10 Sandersons Way, Blackpool, FY4 4NB  
Email:enquiries.ematic@adivision.co.uk  
Web:www.e-matic.co.uk

